

# Removing the Guesswork for Properly Fitting a Crown

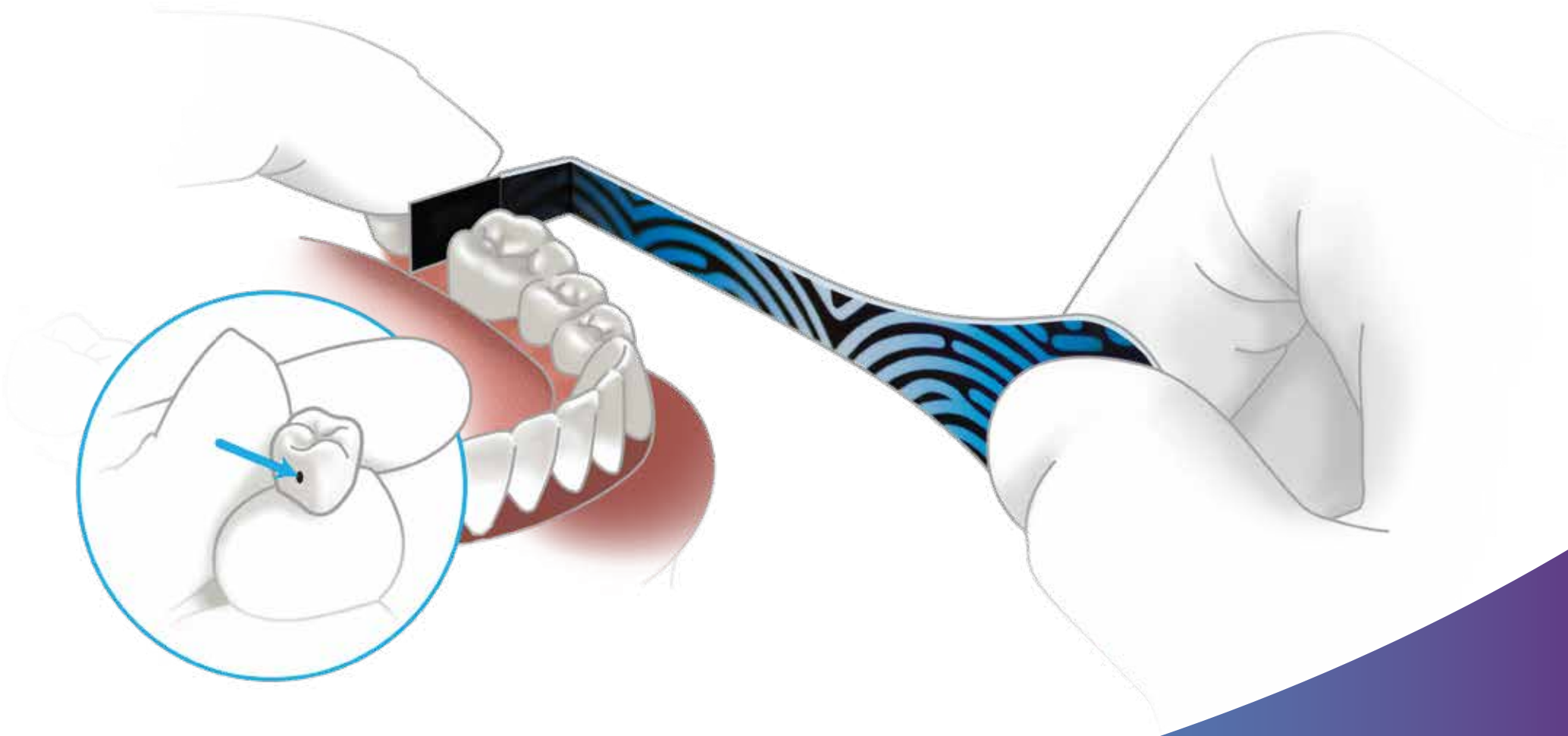

## Get a Handle on Adjustments™

Adjusting tight interproximal contacts when seating a restoration such as a crown, bridge, implant, inlay, onlay, or almost any other prosthesis, can be difficult and time consuming.

In the past, there was really no good way to mark contacts, leaving dentists to play the guess and check game. Microcopy's PROXI-CHEK offers a new way for dentists to accurately mark contacts for adjustment, ensuring complete marginal seating, maximizing efficiency and leading to more predictable results.



PROXI-CHEK saves time when fitting prosthesis by simplifying adjustments.

Dr. Parag Kachalia, DDS  
San Ramon, CA

## The Importance of Proper Seating

Fitting a crown is a routine procedure in the dental practice. Whether restoring a tooth, completing an implant with a crown fit to an abutment, or placing a bridge, patients expect to leave with a beautiful, comfortably fitting restoration that will last for years.

While seating crowns might seem like an easy task for the experienced dentist, achieving the proper fit can be challenging. Crowns need to fit perfectly to provide patients with the esthetics, function and longevity. When crowns do not fit properly, it can result in:

- Incomplete marginal seating
- Inability for the patient to properly care for adjacent teeth and the crown
- Abrasion to adjacent teeth
- Opposing tooth may also be impacted with high contact points

These problems can be exacerbated by modern dental materials which can be harder than the tooth they are replacing.



## Symptoms of improper seating

Patients may subsequently experience these symptoms and feel less than satisfied with their experience:

- Pain
- Hypersensitivity
- Marginal decay

## Common Stumbling Blocks

While most dentists place a lot of crowns that doesn't mean it's always easy. To ensure the restoration lasts and is comfortable for the patient, the fit has to be right.

- Tight interproximal contacts will cause the crown to not seat properly
- Marking and checking contacts can be tricky, and trying to incorporate methods that require forceps or that produce inaccurate markings can lead to inefficient use of chairtime
- Over adjusting the crown risks having to send it back to the lab
- Removing excess cement can be difficult and even uncomfortable for the patient, and if not removed, can cause irritation



Proximal contacts are usually the toughest thing to get exactly right.

The ability to use PROXI-CHEK, which is a small piece of articulating film on a handle, allows you to mark tight proximal contacts, which makes your life more predictable and easier. And there's less adjusting because the film actually marks the spot where it's binding.

Dr. Ron Kaminer, DDS  
Hewlett, NY

## A New Solution has a Predictable Outcome

It's important to follow the proper steps when seating a crown, and that includes making adjustments if it doesn't fit right on the first try. When a contact is too tight, dentists often use a guess and check method to seat the crown, simply because they don't have a better way to determine how much and where they actually need to reduce. This not only takes time, it also means placement won't be as accurate as it could be. Traditional methods for marking contacts prior to adjusting the crown can be time consuming and the results can be less than accurate.

There are ways to make this process easier and more predictable, including the new interproximal marker from Microcopy, PROXI-CHEK. Made of a small piece of articulating film with an easy-grip handle, this simple, easy-to-use tool takes the guesswork out of the crown seating process—and that makes the process more efficient, leading to more predictable outcomes and happier patients.



Dentists do different things (to mark contacts). They can spray the proximal wall of the tooth. Some will take a pencil and use graphite and rub it on the side of the tooth. When it rubs off you know where the spot is that's binding. Other dentists just do it by eye, and haphazardly remove part of the crown. When you do it that way you very often end up taking out areas that don't need to be removed.

Dr. Ron Kaminer, DDS  
Hewlett, NY

## PROXI-CHEK Advantages

The only interproximal device that combines a precise mark of the contact with simplicity to eliminate the guesswork for properly fitting a crown. The single-use, economical interproximal marker can be used on all types of crowns including zirconia, porcelain, lithium disilicate and metal.

- Thin 19 micron film makes a small, precise mark for accuracy
- Economical, ready to use tool
- Single-patient-use



PROXI-CHEK's thin film leaves a black mark just on the point of contact. The visible mark makes it easy to reduce areas where the contacts are too tight, resulting in a broad, tight contact.



It's the same concept as adjusting someone's occlusion. You can see what needs to be adjusted and only adjust that versus going too far and then adding a contact.

It's a major time saver when you don't have to add a new contact. And if it saves you time, it makes you more productive.

Dr. Hugh Flax, DDS, AAACD, MICOI  
Atlanta, GA

## Communicating with Patients During Seating

When you need to make adjustments, patients might not understand what you're doing, making them anxious while they're in the chair. Products such as PROXI-CHEK and BITE-CHEK® make it easy to explain what you are doing and why, putting their concerns to rest. It also helps save chairtime and be more efficient. The sooner the patient is finished the happier they will be, a win win for everyone.

“I have a lot of patients who want to know why we're adjusting their crown,” said Dr. Hugh Flax, who's been using PROXI-CHEK. “A lot of times we'll get them involved and say, ‘see this dot, that's where I'm adjusting the bite,’ or ‘this is why we're adjusting the contact.’ It gives patients more certainty the treatment is being done properly. They know how we're keeping score.”

Dr. Flax places CAD/CAM crowns in his practice, and decided to delegate adjustments to his assistants when he made the switch to digital restorations. While he's comfortable making adjustments by feel, his assistants aren't as experienced. They simply need more visual input. Before PROXI-CHEK, they had to rely on trial and error when making adjustments, which took up extra time chairside. Now, his assistants look for the dot that indicates where the crown is binding so they can quickly and easily make the correct contact reductions.



## PROXI-CHEK features:

- Thin black film precisely marks points of contact to eliminate the guess work in adjustments.
- Thin 19-micron film provides tactile feedback for proximal fit.
- Double-sided film marks both the prosthesis and the adjacent tooth.
- Easy-grip handle is made to easily reach the posterior.
- Handle bends at 90° for posterior adjustments.

## Instructions for Use



1. Dry prosthesis and tooth surface.



2. Use straight in the anterior. When working in the posterior, with the crease facing up, pinch down for 2 seconds.

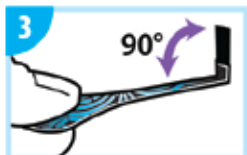

3. Release for a 90° angle.



4. Position film next to the adjacent teeth and insert the prosthesis. Slightly pull to create a mark.



5. Remove prosthesis. Adjust at the mark. Repeat until the prosthesis seats.



## Steps to Seat a Crown

A properly fitted crown will stand the test of time. These steps include:

### Fit check the crown on the stone model

- Make any adjustments before the appointment.

### Numb the tooth (if necessary)

- Ensure the patient is comfortable.

### Remove the temporary crown

- This step is not necessary with a CAD/CAM crown.

### Check the proximal fit

- Seat the crown for proper fit.
- If the crown fits too tight, make the adjustments until the proximal contacts are ideal and the crown seats correctly. Use NEODIAMOND® 1116.8F or 3116.8VF for very fine proximal adjustments.
- Instead of guessing, mark with PROXI-CHEK to ensure a smooth, broad contact.

### Polish the adjusted crown

- Polish any adjusted surface to protect from discomfort, bacteria adhesion, and abrasion to the opposing teeth.

### Cement the tooth

- Place the cement and seat crown. Remove any excess cement.

### Check occlusion

- Check the bite for proper occlusion, and make any adjustments. See BITE-CHEK®.
- Use NEODIAMOND® 1923F or 3923VF for very fine occlusal adjustments.

### Ensure patient satisfaction

- A proper fit eliminates complaints.

## Simplify Occlusal Adjustments

BITE-CHEK articulation film from Microcopy with its easy-grip handle eliminates the need for forceps. Its thin film accurately marks high points and stretches without snapping back or tearing, which helps prevent false marks. Its patented design is available in black/black and red/black.



## No More Guessing

As a dentist, you know how important it is to invest in products and to learn techniques that save valuable chairtime and promote efficiency—not to mention that help ensure you provide patients with natural-looking, long-lasting restorations that look and feel great. When placing crowns, if contacts are off a little, it can have a negative effect on the final outcome. Rather than guessing, now you can use PROXI-CHEK, an interproximal tool that makes it clear where the contacts are and what needs adjusting. This simply makes the process easier, and the crown placement a success that will last for many years.

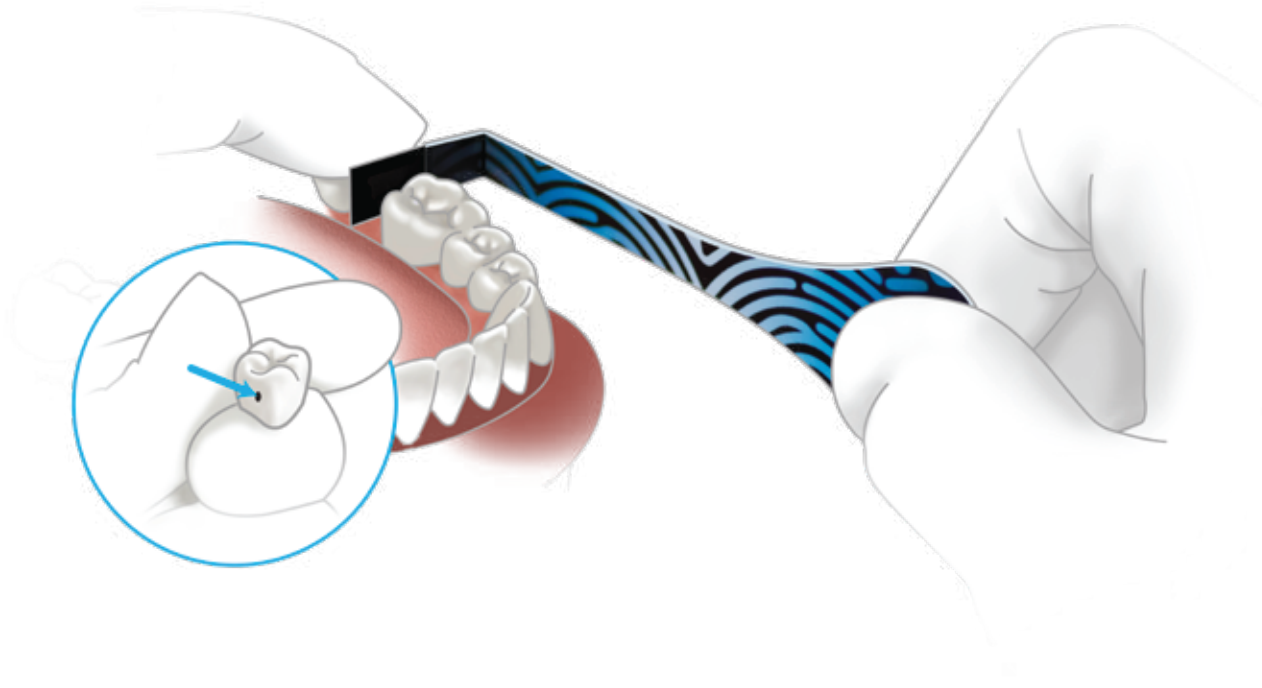

Tight proximal contacts is a common problem most dentists have, even with the best of labs. Bottom line, it's about predictability. At the end of the day being able to easily adjust the contact gives us more predictable results.

Dr. Ron Kaminer, DDS  
Hewlett, NY

***PROXI-CHEK***<sup>TM</sup>  
Proxi-Chek.com  
800.235.1863

